

If you experience a false alarm whilst testing the system, it is likely because the connection between the tag and the Core was broken for longer than 3 seconds. If this occurs carry out the following steps to adjust your system.

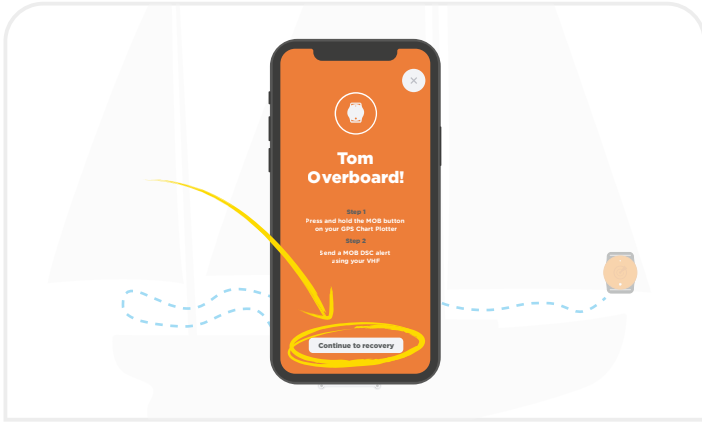

1. Accept the alarm with the OLAS App.

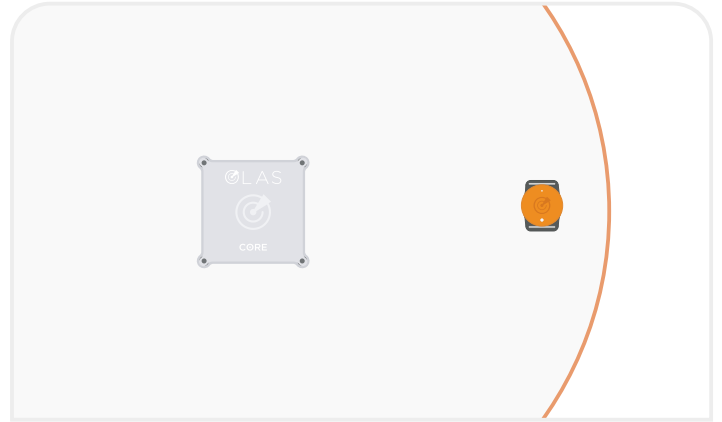

2. Bring the tag within 1 metre of the Core.



3. Cancel the alarm on the Core by pressing the control switch once.

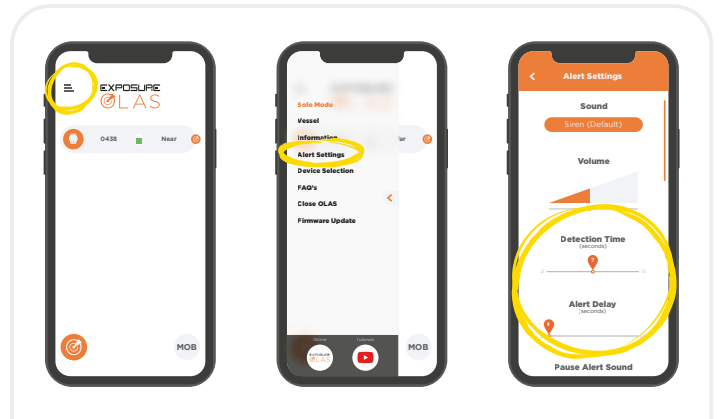

4. Navigate to the Alert Settings in the OLAS App.

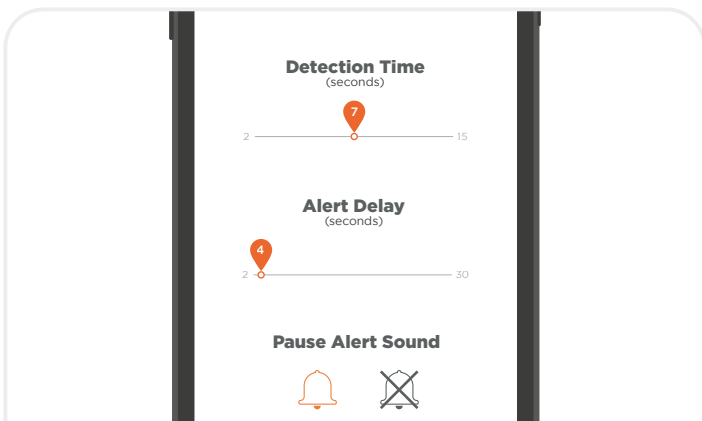

5. The Alert Delay period is a time where the Core will be beep rapidly and the control switch will flash red. This is an indication that a tag is about to set off the MOB alarm. During this period if the tag is brought back into range the alarm is automatically canceled. This can be a very helpful setting to help test the limits of your setup.

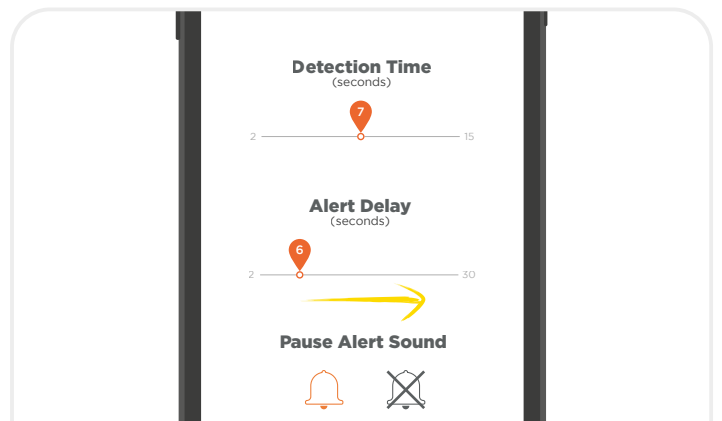

6. Increasing the Detection Time allows more opportunity for the OLAS tag to reconnect silently, and therefore not activating the alarm.

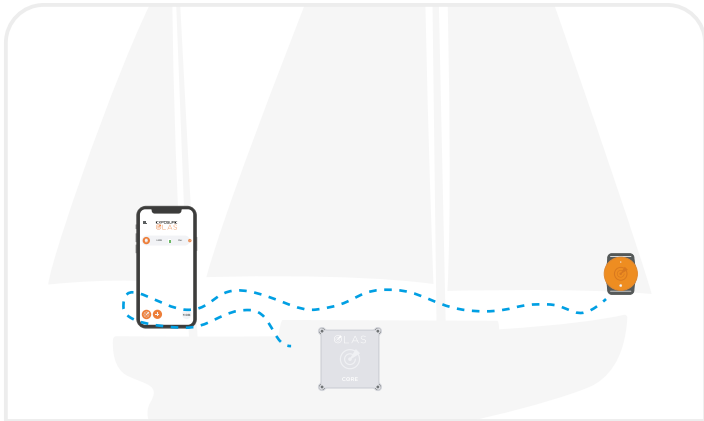

7. Walk to the location where the tag previously set off the alarm and then continue walking around the vessel.

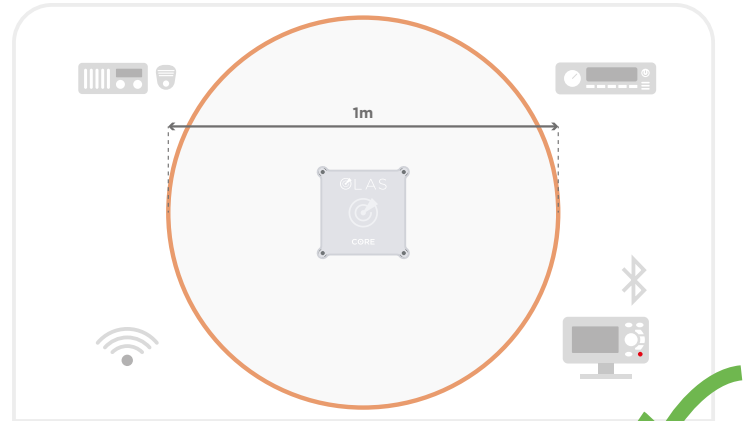

8. You should always try to install your Core at least 0.5 meters from any equipment transmitting radio signals including VHF Radios, antennas and cables.

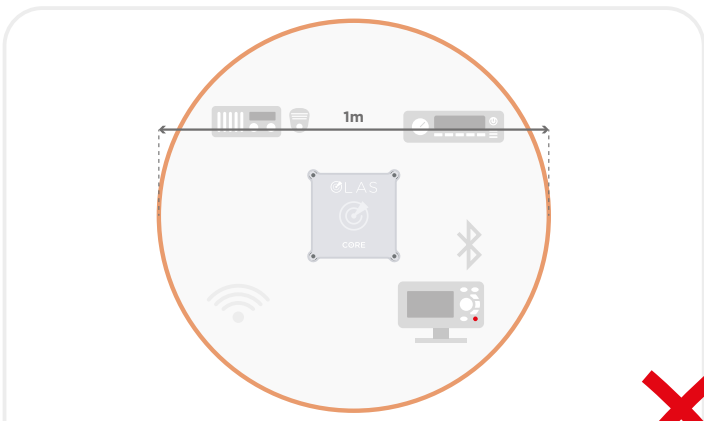

9. If located within 0.5 meters it is possible false alarms may occur. If you are experiencing false alarms try moving the Core hub away from other electrical devices and then carry out the Core setup and range test to see if the false alarms still occur.

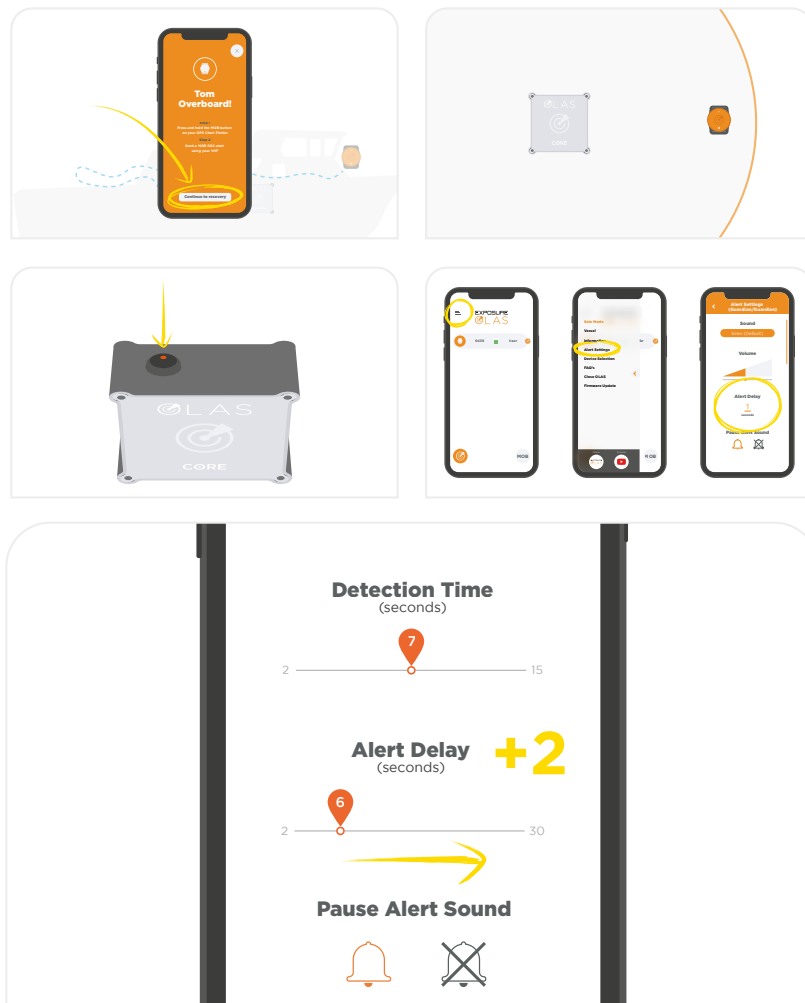

10. If a false alarm sounds again return to step 1 and increase the Detection Time and Alert Delay so that the system offer effective coverage around your vessel without activating the MOB alarm.

If false alarms continue an additional OLAS Extender is required to cover the signal 'black spot'. Using an Extender will also allow you to reduce the 'Alert Delay' back done to the default of 4 seconds. Up to 2 Extenders can be used in one system. Increasing the potential length of vessel that the system can cover up to 100ft.